

USA & THE ARCHITECTURE OF DEMOCRACY

An Architecture of Democracy?

Diaspora of the Avant-Garde, European artists fleeing Hitler:

Russia: E. May, H.Meyer, G. Schutte-Lihotzky, B. Taut; Japan: B. Taut

Turkey: C. Holzmeister, H. Poelzig, B. Taut, O. Kaufmann, M. Wagner

Mexico: H. Meyer, M. Osborn, M. Cetto; Israel/Palastine: Mendelsohn, O.

Kaufmann; England: Gropius, Mies, Mendelsohn

USA: Gropius (Harvard), Mies (IIT), Mendelsohn (Berkeley), Saarinen

(Cranbrook), Aalto (MIT), Breuer (Harvard), Giedion (Harvard), M. Wagner

(Harvard), Moholy-Nagy (IIT), Hilberseimer (IIT), Albers, Klee, W.C. Behrendt

(Darmouth), Gutkind (Penn), Konrad Wachsmann (CMU)

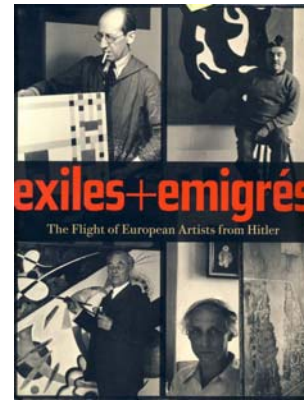

Erich MENDELSON (1887-1953)

Travelled to USA 1924, friend of F.L. Wright, mentor of Neutra, Schindler...

Biggest modernist architecture office in Europe

Exile in Palestine, 1933-41

* Medical Center, Hebrew University, Jerusalem, 1937 (p.383)

cf. Synagogues in Cleveland Heights, OH, St. Louis, MO, StPaul. MN 1946-50



Walter GROPIUS (1883-1969)

Founding Director of Bauhaus, 1919-1928

Emigrates from Germany 1934, to England, then US, 1937

Chair of Architecture at Harvard, 1937ff

* Gropius Own House, Gropius, Lincoln, MA, 1937 (p.396)

Frank House, Breuer & Gropius, Pgh, 1937

cf. Aluminum City Terrace, New Kensington, PA 1942

* Harkness Commons (Harvard), Gropius, Cambridge, MA, 1948 (p.397)

The Architect's Collaborative (TAC) with Benjamin Thomson

PanAm Building, TAC with Belluschi & Emery-Roth, NYC, 1965

Athens Embassy

Chase Manhattan Bank, Great Neck, NY



Ludwig MIES VAN DER ROHE (1886-1969)

Head of Werkbund, Last Chair at Bauhaus, 1933

Emigrates to US 1937

Chair of Architecture at IIT 1939ff

* Farnsworth House, Mies v.d. Rohe, Plano, IL, 1945-51 (p.403)

* IIT Campus Plan, Mies v.d. Rohe, 1939-56, incl. Crown Hall Architecture, 1950-56, (p.401-2)

* Lake Shore Drive Apts., Mies v.d. Rohe, Chicago, 1948-51 (p.394,407)

Seagram Building, Mies v.d.Rohe & P. Johnson, NYC, 1954-8 (p.408)

* New National Gallery, Mies van der Rohe, Berlin, 1962-8 (p.645)

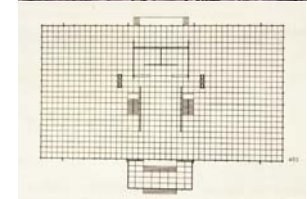

Corporate Modern / Skidmore Owings & Merrill (SOM)

Heinz Vinegar Plant, Pittsburgh, SOM/Bunshaft, 1950

* Lever House, SOM & Bunshaft, New York City, 1951-2 (p.409)

Manufacturer's Hannover Bank, New York City, SOM & Bunshaft, 1953-4

Inland Steel, Chicago, SOM & Bunshaft, 1955-58

Equitable Life Assurance, P. Belluschi, Portland, OR, 1944-7 (p.407)

Alcoa Building, Harrison & Abramovitz, Pgh., 1953

Time-Life Building, Rockefeller Ctr., NYC, Harrison & Abramovitz, 1959

Emery Roth & Sons': architects to NYC's corporations

* UN Building, Harrison & Abramovitz (& Le Corbusier), NYC, 1947-50 (p.410-11)

* Point Park & Gateway Center, by Eggers & Higgins, 1950-56

Precedents: Le Corbusier's "Towers in the Park" (1922ff)

Eggers & Higgins' Stuyvesant Town in NYC, 1943-47

