

assignment 4

01.27.06.F issued

01.30.06.W due

design

mobile library

1. drawings and revisions

- edit model from Friday as necessary
- draw – good quality study drawings of 3d views (axon, isometric or perspective) on trace. 1 of primary exterior portion, 1 of primary interior portion. (not 'Cooper' like sketches, but good architectural line drawings). Drawings may be hard-line or good free hand drafted demonstrate study of alternative design options. These are design drawings not presentation drawings.
- detail – begin to suggest materials on models and drawings, show people, etc. for scale and context

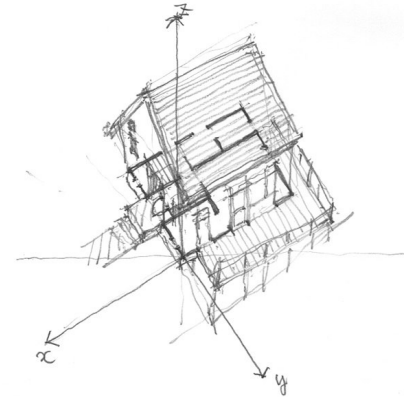

2. find

- images of materials you are considering in context
- details and sections of these materials

initial material research...phase 2

metal + wood

1. submit: copy of research to date based on assignment 3 requirements (hard copy) and .pdf email to lcalisti@andrew.cmu.edu or lee@leecalisti.com

