



# Project Proposals

Mehru Nikhil Singh

[mnsingh@andrew.cmu.edu](mailto:mnsingh@andrew.cmu.edu)

[mehru.singh@kennametal.com](mailto:mehru.singh@kennametal.com)

Global CAD & Design Automation

Feb 11<sup>th</sup>, 2016



## Requirements:

- Determine Unbalance
- Compute the balancing masses and distance

## Technology To Be Used:

- Language                   :-- C++
- CAD Package               :-- NX9
- API                         :-- NXOPEN / UFUNC
- IDE                         :-- VS 2012

## Dynamic Balancing

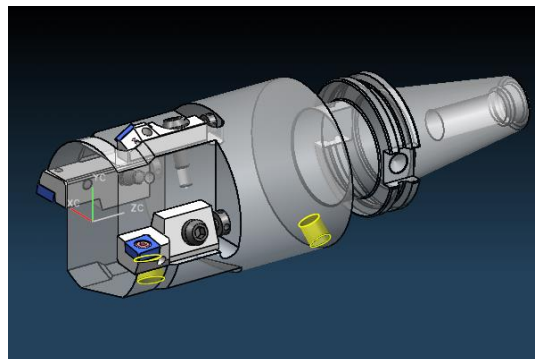
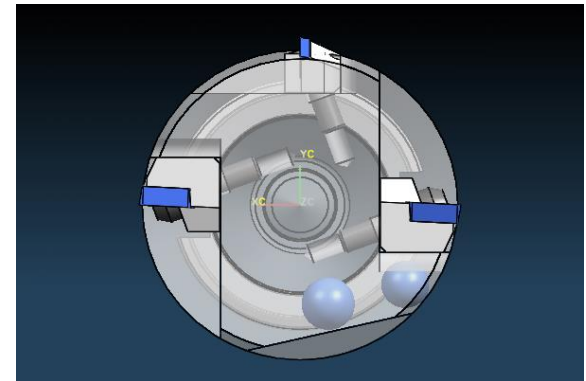
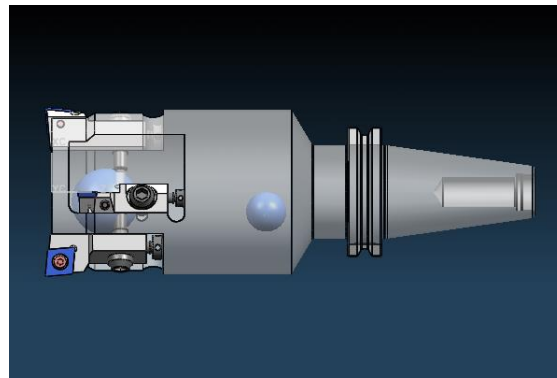
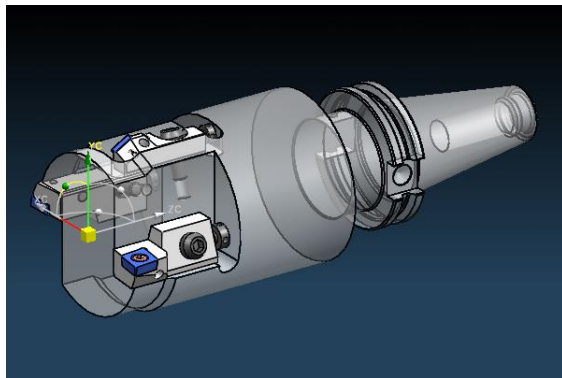
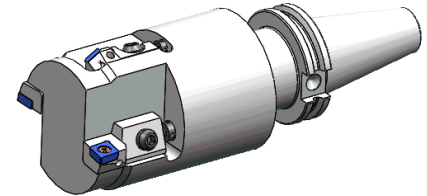

```

=====
Information listing created by : philipd
Date : 22/09/2005 17:21:36
Current work part : E:\ugii\projects\balancing\9999910amr00.prt
Node name : ehw000001
=====
Centroid Result
=====
Mass : ,4856.2957092, [gram]
Centroid Position X : ,-.0000000, [mm]
Centroids Position Y : ,-.0001352, [mm]
=====
Balance Quality
=====
RPM <n> : ,2500.0000000, 1/min
Angular Speed <omega> : ,261.7993750, [1/s]
Centroid Deviation <e> : ,.0001352, [mm]
Balance Quality <G> : ,.0353890, [mm/s]
=====
    
```

# BREAD & BUTTER OF KENNAMETAL

